



*Diane Moore*

Associate Broker

diane@dianemoore.ca

www.dianemoore.ca

**PREMIER**  
CANADIAN PROPERTIES

**CELL: (250)868-1780**

OFFICE: (250)717-1886

TOLL FREE: 1-877-717-1886

*Moore Service*

*Moore Reliability*

*Moore Integrity*

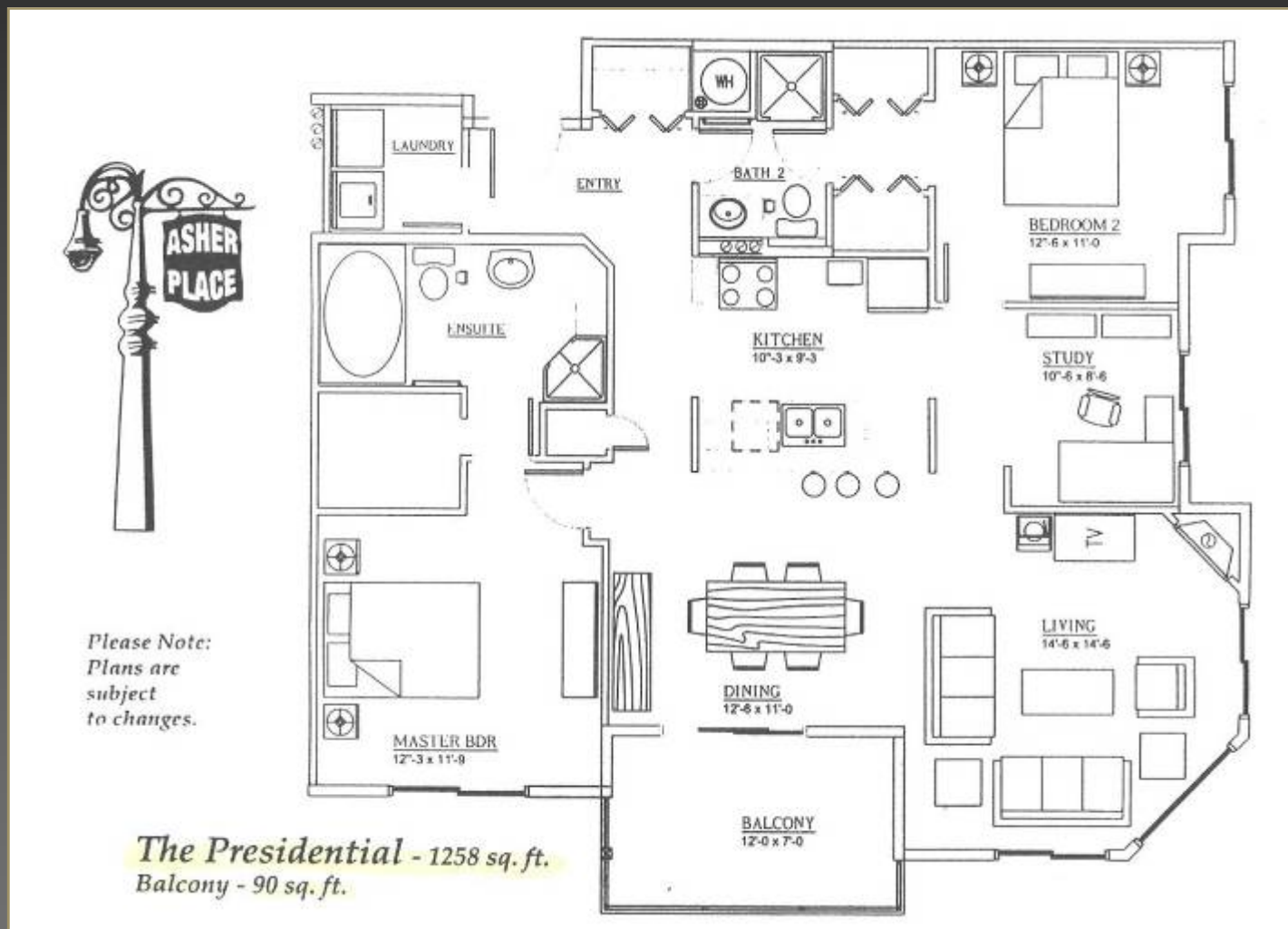

**#208 - 140 Asher Road**  
*Asher Place*

Spacious 2 bedroom, 2 bathroom plus den corner unit  
Panoramic views of the valley and mountains  
Great central location  
Close to Golf Courses, World Class Ski Resort and Wineries



Complex has a guest suite, exercise room, media room & Zen-like gardens with Gazebo.

Building was a Tommie Award Winner in 2007.

**\$279,900**

MLS® #10031683



## Features

- Corner unit flooded with natural light.
- Panoramic view of mountains, city and valley.
- Electric fireplace in living room.
- Engineered maple hardwood floors.
- Corridor kitchen, maple cabinets, numerous pullouts.
- Open concept dining area with sliding glass door to deck.
- Spacious master bedroom with walk in closet.

## Features

- 4 piece ensuite with walk in shower and soaker tub
- 2nd bedroom has ensuite door to 3 piece bathroom
- Sliding glass door at den/office to terrace
- This unit has a balcony off dining area, plus a 328 sq ft terrace to enjoy endless sunsets
- Terrace patio has a gas barbecue hook up, water tap and timber arbor
- Secure entrance with phone intercom
- 1 secure underground parking stall, and covered visitors parking
- Suite includes a storage unit on the same floor
- Inclusions: dishwasher, dryer, microwave, refrigerator, electric stove, dryer, window coverings
- Freshly painted

## Room Dimensions

Living Room	14'6 x 14'6
Dining Room	12'6 x 11
Kitchen	10'3 x 9'3
Master Bedroom	12'3 x 11'9
Bedroom 2	12'6 x 11
Den/Office	10'6 x 8'6
Deck	12 x 7
Patio	16 x 20
Bathroom	3 piece
Ensuite	4 piece

All measurements are approximate

**Total 1,258 sq ft**

Built in 2007

Taxes \$1,496 (Year 2010)

Strata Fees \$256

Information from sources deemed to be accurate but must be verified.

